



32 The Poplars, Littlehampton BN17 6GZ
£360,000 Freehold

**HAWKE &
METCALFE** 
INDEPENDENT ESTATE AGENTS

INDEPENDENT ESTATE & LETTING AGENTS

- End of Terrace House
- New To The Market - Library Photos
- 3 Bedrooms
- 3 Bath/Shower Rooms
- Gas Heating & Double Glazing
- Private Drive & Garage
- No Onward Chain
- Viewing Recommended
- EPC Rating: - 'C'

NEW TO THE MARKET - LIBRARY PHOTOS A modern three storey three bedroom end of terrace house with two en suite shower rooms and a family bathroom. The property offers good size, versatile accommodation and has a private drive to an attached garage.

Features include: - No onward chain, gas central heating, double glazing and a ground floor cloakroom.

We would recommend internal viewing to fully appreciate the good size accommodation.

The Poplars is a modern residential area pleasantly situated mid-way between Rustington and Littlehampton and is accessed from Worthing Road.



Ground Floor

Approx. 35.9 sq. metres (386.5 sq. feet)

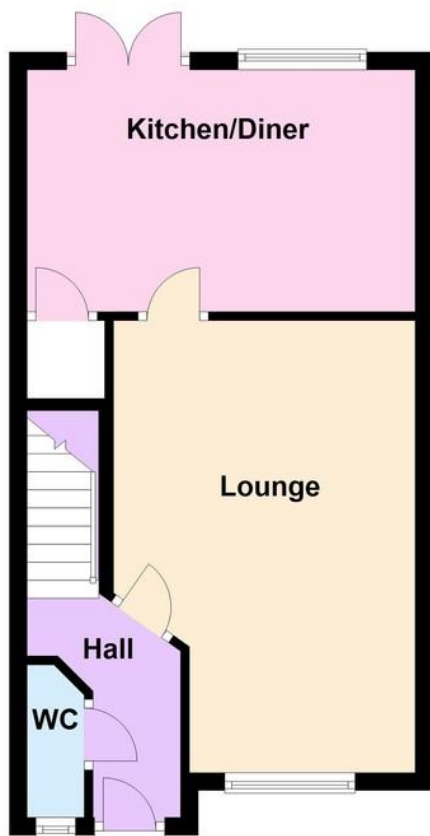

First Floor

Approx. 35.2 sq. metres (378.5 sq. feet)

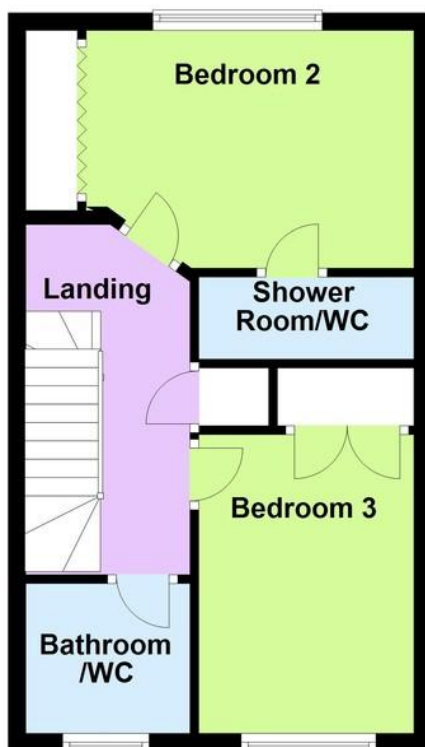

Second Floor

Approx. 24.7 sq. metres (265.6 sq. feet)

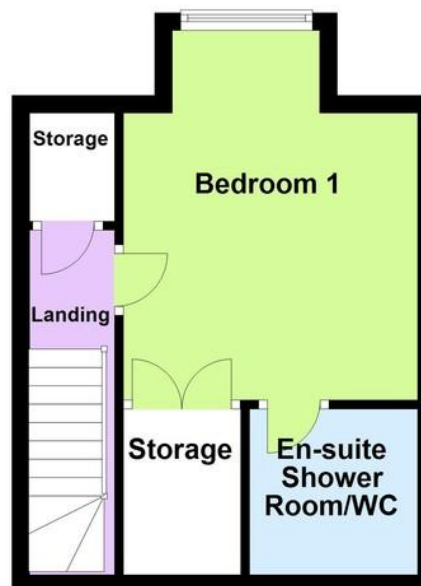

Total area: approx. 95.7 sq. metres (1030.6 sq. feet)

ENTRANCE HALL

GROUND FLOOR CLOAKROOM

LOUNGE

16' 10" x 11' 3" (5.13m x 3.43m)

KITCHEN/DINER

14' 6" x 8' 11" (4.42m x 2.72m)

BEDROOM 1

12' 7" x 11' 2" (3.84m x 3.4m)

EN SUITE SHOWER ROOM/WC

BEDROOM 2

12' 3" x 8' 10" (3.73m x 2.69m)

EN SUITE SHOWER ROOM/WC

BEDROOM 3

11' 1" x 8' 0" (3.38m x 2.44m)

BATHROOM

PRIVATE DRIVE

ATTACHED GARAGE

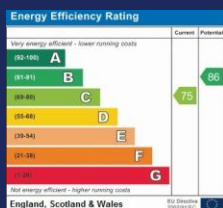

01903 850450

90 THE STREET, RUSTINGTON, WEST SUSSEX,
BN16 3NJ

sales@hawkemetcalf.co.uk

www.hawkemetcalf.co.uk

